



BONNEVILLE™
WINDOWS AND DOORS

DOUBLE HUNG SASH REPLACEMENT KIT



W E L C O M E H O M E

WHY USE A SASH REPLACEMENT KIT?

Tools required

Hammer • Phillips Head Screwdriver
Pry Bar • Pliers • Putty Knife



The frame and trim of old double hung windows often remain in good condition, while the sash become a lot less energy efficient. With a Bonneville Sash Replacement system, you need only replace the worn-out sash, and not the frame and interior trim. That saves you time, money, and disruption to the home.

The energy efficiency begins with two 1 3/8" thick Eastern White pine sash. High-quality weatherstripping, insulating glass, and tilt-in features incorporated into new jamb liners, make sash replacement in your home a cinch. Each kit comes with easy-to-follow installation instructions.

Each Bonneville Sash Replacement Kit contains :

- | | |
|--|---|
| <p>1 A pair of wood sashes</p> <p>2 Two jamb liners complete with balances</p> <p>3 A wood parting stop</p> | <p>4 Clips, screws and nails to hold jamb liners</p> <p>5 Installation instructions</p> |
|--|---|

HOW TO MEASURE

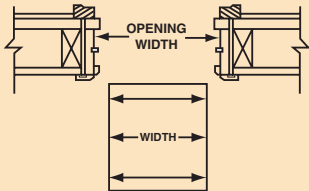

WIDTH

- Measure width of the window sash to be replaced.
- Take measurements from innermost point between jambs at three different locations : top, bottom and middle.
- Always measure from surface of jamb, not parting stop.
- Take note of the smallest of the three measurements. This will be the width of your first new Bonneville Sash Replacement Kit.



HEIGHT

- Now measure height of the window sash to be replaced.
- Take measurement from where the top sash meets head jamb to where the outside of the bottom sash sits on sill when fully closed.
- For precision, take measurements, at three different locations : left, right and middle.
- Take note of the smallest of the three heights for your first Bonneville Sash Replacement Kit.

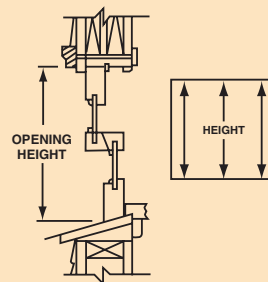

IMPORTANT

- 3 1/2" pocket in the jamb is required for this kit
- Always use smallest width and your height when ordering your replacement kit : **Width x Height**
- Always check sill angle. Our sash and weatherstrip design will fit any angle from 10° to 14° without affecting the efficiency of your Sash Replacement Kit.
- To determine sill angle, use a carpenter's protractor.
- Any variation in dimensions +/- 1/8" will work with width or height of your Bonneville Sash Replacement Kit.

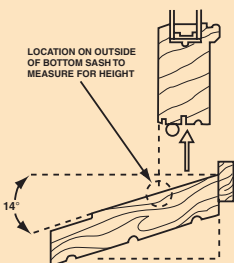

HOW TO INSTALL

This guide has been designed to help you install your Bonneville Sash Replacement Kit. Although most windows can be replaced, Bonneville recommends you consult a professional to get best results.

1

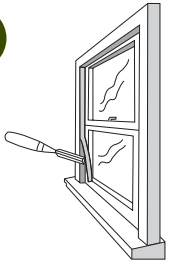

- Remove inside sash stops along of top and sides with a putty knife.
- Then remove parting bead at top of jamb.
- Be careful not to damage sash stops since they will be reused in step 11.

2

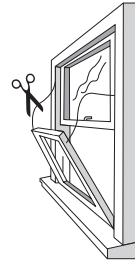

- Cut cords to remove lower sash and to let them drop into the weight boxes.
- If your windows have jamb tracks (either in aluminum or vinyl) bottom sash can be removed by pushing sash to one side of the opening. These tracks can be withdrawn after top sash has been removed.

3

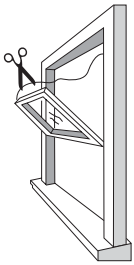

- Lower top sash halfway down and tilt it.
- Cut cords and remove top sash.
- The parting stop can now be removed with a flat pry bar. (This parting stop will not be reused in the new installation).

4

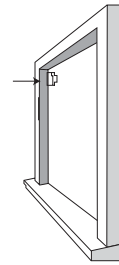

- Remove pulleys on both sides of opening and clean space with a brush or Vacuum cleaner.
- Pack space where pulleys were with insulation.

5

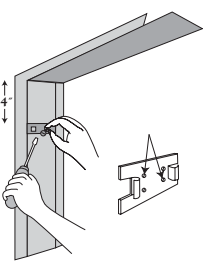

- Mark the locations on the side jambs for balance clips : one 4" from the top, one 4" from the bottom. Space the remaining clips evenly between the top and bottom.
- Install metal clips with screws supplied (2 screws per clip).

6

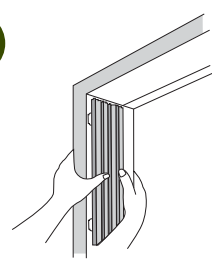

- Snap vinyl jamb liners on by pressing them over the metal clips. Make sure long side of bottom bevel is kept towards the exterior.

7

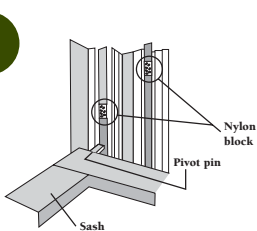

- Make sure to pull nylon blocks down enough to simplify operation 8.
- Pull the nylon blocks down to $\frac{2}{3}$ of the jamb liner with a flat screwdriver.
- Lift the screwdriver very carefully, the nylon blocks will stay in the stop position. Never stop it directly on the sills (never stop at less than 2 inches from the sill).

8



- Install top sash first with the outside surface facing upwards.
- Be sure pivot pins are engaged in jamb liner located on each side of the frame, above nylon blocks.

9



- Tilt sash up to engage it in slides.
- Pull the sash down to engage nylon blocks located on each side of the frame. If both sides are not perfectly engaged, repeat the operation.
- Repeat operation 8 and 9 for bottom sash.
- Both sashes are now in position.

10

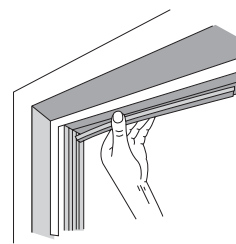

- Measure length required for parting stop.
- Now cut parting stop to this length.
- Install parting stop in line with the middle groove, making sure weather-strip is facing outwards.

11

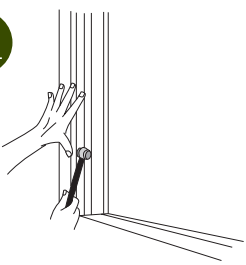

- Replace inside sash stops which were removed in step 1 and nail them back in their original place. Leave a small space between sash stops and jamb liners (about $\frac{1}{32}$ of an inch).
- Check the waterproofness of your new installation.
- Your new window is now installed.

Important note:

Bonneville is not responsible for Sash Replacement Kits installed in openings that are not square, plumb or otherwise structurally sound. Specific circumstances may require that installation methods and materials be adapted.

FEATURES

This high-quality product comes in a range of standard or custom sizes to fit any opening. Sashes are available in natural wood, factory-primed, or with low-maintenance aluminum cladding in four optional colors. Enhance them with high-performance Low-E argon glazing, and any one of variety of grilles : removable in wood or aluminum cladding, simulated divided lite, or aluminum grilles inside insulating glass. Choose from white or tan-colored hardware and balances. No two ways about it, Bonneville is the choice when it comes to sash replacement kits. Drop by your local window specialist and ask for more information on these fine products.



STANDARD

- Tilt mechanism for easy cleaning
- Eastern White pine construction
- Standard insulated glass
- Weatherstripping at top and bottom, and meeting rail to help keep air and moisture out
- Jamb liners with plastic wrap foam for extra air tightness and help reduce drafts
- Pre-installed lock and pivot pins
- Available in standard and custom sizes

OPTIONAL

- High-performance sealed units (Low-E argon glazing)
- High-efficiency spacer bar that reduces condensation problems
- White or ivory colored jamb liners and white or coppertone hardware to match the final finish of your windows
- Outside cladding in four different colors (white, bronze, sandalwood, or green) The inside stays natural for the finish of your choice
- Possibility of having sashes primed and ready for painting
- Screen available separately
- Variety of grilles: - Removable (wood or aluminum clad)
- Simulated divided lite
- Georgian grilles in airspace



White



Nutmeg



Sandalwood



Green



Wood or aluminum clad removable grille



Interior aluminum Georgian grille in airspace



Simulated divided lite with or without spacer bar

WWW.BONNEVILLEWD.COM



CANADA
274 Duchesnay Street
P. O. Box 1000
Ste. Marie Quebec G6E 3C2
Tel.: 1-800-463-8875
Fax: 1-800-463-4020

UNITED STATES
20B Deer Park Drive
East Longmeadow, MA 01028
USA
Tel.: 1-800-854-9504
Fax: 1-866-525-7555

